

CHECK VALVES

Hi-Kalibre Check Valves are an inline, piston type check which will work in any orientation – horizontal, vertical or slant line. These checks have high volume flow in the forward direction, and produce gas tight sealing in the reverse direction.

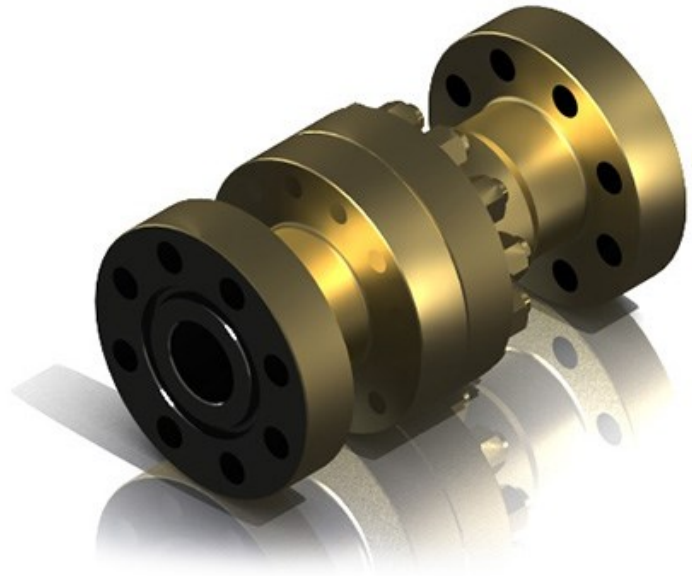

DESIGN FEATURES INCLUDE:

- Wide variety of size and end connection options
- Forged body and bonnet construction
- Durable polymer low pressure seal backed by high pressure metal to metal seal, spring energized to ensure positive sealing in any condition
- Works in any orientation: horizontal, vertical or slant
- Fully NACE compliant
- Available in a wide variety of sizes and end connections
- Reliable, field proven, serviceable design

Series	ID (")	Flange Type	Sealing Mechanism	Service	Length (")	Weight (lbs.)	Pressure (psig)	Alternate End Connections / Configurations
HK-C2036	2.00	Flange Swivel	Flapper	NACE	4.50	30	3000	Weld End, Hammer Union, NPT, API
2350-SERIES	2.06	API R-24	Plug	NACE	14.63	132	5000	API
3150-SERIES	3.12	API R-31	Plug	NACE	17.13	165	3000	API
3351-SERIES	3.12	API R-35	Plug	NACE	18.63	245	5000	API
3361-SERIES	3.06	API BX-154	Plug	NACE	24.35	280	10000	API

***Contact Hi-Kalibre Equipment for custom check valve sizes or configurations